

EXHIBITING RATES PER SQ.M – BARE AREA <sup>(1)</sup>	
<b>BASIC RATE</b>	€/Sq.m 140,00
<b>EARLY BIRD RATE</b> <i>-30% only if confirmed by 31<sup>th</sup> July 2022</i>	€/Sq.m 98,00

EXHIBITING RATES PER SQ.M – FITTING PACKAGES <sup>(2)</sup>	
<b>SHOP FITTING PACKAGE</b>	€/Sq.m 60,00
<b>STANDARD FITTING PACKAGE</b>	€/Sq.m 70,00
<b>NEW ! FURNITURE PACKAGE<sup>(3)</sup></b>	€/each 195,00

**Other items:**

<b>Registration fee (compulsory for each exhibitor)</b> includes: insurance, exhibitors' badges according to exhibit area, listing in the official catalogue, digital ticket invitation, 1 parking permit, Wi-Fi connection	<b>€ 300,00</b>
Preferential Area Surcharge <sup>(4)</sup> (for stands in a corner position) on total bare area rate	<b>+ 10%</b>
Preferential Area Surcharge <sup>(4)</sup> (for stands with 4 display fronts and/or stands) on total bare area rate	<b>+ 15%</b>
Hosted companies fee (in case of more companies inside one booth)	<b>€ 1.000,00</b>

VAT must be added to these figures, if due.

- (1) **Bare area** rate includes area and 1 kw supply each 16 sq.m. The registration fee and any other item required will be charged.
- (2) **Shop Fitting Package** and **Standard Fitting Package rate** include stand structure, dividing walls, carpet, spotlights and socket, company name board but they **DO NOT include bare area fee**.
- (3) The **Furniture Package** can be added to the Shop Fitting Package or to the Standard Fitting Package, the rate includes: storage cm 100x100, 1 table, 3 chairs, 1 wastebasket, 1 coat rack, 1 reception desk and 1 stool.
- (4) **Preferential Area Surcharge:** supplementary rate for areas looking on to entrance corridors and/or corridors connecting Pavilions and/or areas in a corner position. It is calculated only on total bare area cost even if the booth is a fitted area.

Further details and costs of participation are indicated in the General Rules and Regulations of Exhibition:

<https://en.koinexpo.com/exhibit/participate/application-forms>

**TECHNICAL FORM KOINE' 2023**  
**GENERAL INFORMATION AND DEADLINES**

**13-15 FEBRUARY 2023**

**IMPORTANT DEADLINES**

<b>BOOKING SPACE AND TECHNICAL DATES</b>	<b>REGISTRATION PROCEDURE</b>	Fill in and send the application form to email <a href="mailto:expo@iegexpo.it">expo@iegexpo.it</a> in pdf format. KOINE' Team will contact you with a customized proposal.	
	<b>AREA ALLOCATION STARTING</b>	<b>1<sup>st</sup> MAY 2023</b>	
	<b>PARTICIPATION CONFIRM</b>	Exhibiting proposal, signed for acceptance, must be sent via email to <a href="mailto:expo@iegexpo.it">expo@iegexpo.it</a> in pdf format. Deposit must be paid for the sum and to the bank account as indicated in the same proposal.	
	<b>BALANCE DEADLINE</b>	<b>24<sup>th</sup> JANUARY 2023</b>	<b>BALANCE DEADLINE</b>
<b>WITHDRAWAL RULES</b>	<b>BOOTH PROJECT APPROVAL</b>	<b>20<sup>th</sup> DECEMBER 2022</b>	<b>BARE AREAS:</b> cut-off date for the <b>presentation of stand fitting &amp; layout design</b> to upload in the section "stand projects" in the reserved area
	<b>SERVICES ORDERING</b>	<b>24<sup>th</sup> JANUARY 2023</b>	Cut-off date for the presentation of the forms for ordering services (See online reserved area on the website)
<b>WITHDRAWAL RULES</b>	<b>31<sup>st</sup> OCTOBER 2022</b>	in case of withdrawal <b>within 31<sup>st</sup> October 2022</b> the penalty will be equal to the <b>registration fee (€ 300,00+VAT)</b> specified in the participation proposal countersigned for acceptance	
	<b>1<sup>st</sup> NOVEMBER 2022</b>	in case of withdrawal <b>from 1<sup>st</sup> November 2022 to 20<sup>th</sup> December 2022</b> the penalty will be equal to a sum corresponding to the <b>advance payment</b> specified in the participation proposal countersigned for	
	<b>From 21<sup>st</sup> DECEMBER 2022</b>	In case of withdrawal starting <b>from 21<sup>st</sup> December 2022</b> , the penalty will be equal to a sum corresponding to the <b>entire amount</b> as quantified in the participation proposal countersigned for acceptance.	

**FOR FURTHER INFORMATION:**

	<b>SECTOR</b>	<b>TEAM</b>	<b>PHONE</b>	<b>E-MAIL</b>
Info for exhibitors, exhibiting space sale, advertising services sale, exhibition general information	Exhibition Manager	Valentina Fioramonti	+39 0444 969990	<a href="mailto:valentina.fioramonti@iegexpo.it">valentina.fioramonti@iegexpo.it</a>
	Sales Account & Coordination	Stefano De Rigo	+39 0444 969962 +39 335 5750166	<a href="mailto:stefano.derigo@iegexpo.it">stefano.derigo@iegexpo.it</a>
	Sales Account	Valentina Dario	+39 0444 969841 +39 334 2742548	<a href="mailto:valentina.dario@iegexpo.it">valentina.dario@iegexpo.it</a>
		Chiara Fizzotti	+39 0444 969843 +39 348 8677239	<a href="mailto:chiara.fizzotti@iegexpo.it">chiara.fizzotti@iegexpo.it</a>
<b>Technical assistance:</b> logistics and planning fitting days, dismantling days, access procedure, stand projects approval	Exhibition Design / Fittings Dptm	Giampaolo Rizzo	+39 0444 969 993	<a href="mailto:giampaolo.rizzo@iegexpo.it">giampaolo.rizzo@iegexpo.it</a>
	HSE & Quality / Safety Dptm	Mattia Gasparini	+39 0444 969818	<a href="mailto:mattia.gasparini@iegexpo.it">mattia.gasparini@iegexpo.it</a>
		Alberto Fioretti	+39 0444 969911	<a href="mailto:alberto.fioretti@iegexpo.it">alberto.fioretti@iegexpo.it</a>
	Logistics & Mobility Dptm	Ivan Giachin	+39 0444 969929	<a href="mailto:ivan.giachin@iegexpo.it">ivan.giachin@iegexpo.it</a>
Luca Sportiello		+39 0444 969949	<a href="mailto:luca.sportiello@iegexpo.it">luca.sportiello@iegexpo.it</a>	
Marta Noaro		+39 0444 969855	<a href="mailto:marta.noaro@iegexpo.it">marta.noaro@iegexpo.it</a>	
<b>Accounting services:</b> deposit payment, balance, invoices, request of invoices	Accounting Dptm	Antonio Cipolletta	+39 0444 969920	<a href="mailto:antonio.cipolletta@iegexpo.it">antonio.cipolletta@iegexpo.it</a>
		Stefania Fin	+39 0444 969970	<a href="mailto:stefania.fin@iegexpo.it">stefania.fin@iegexpo.it</a>
<b>Forms and catalogue assistance</b>	Back Office	Barbara Bertoglio	+39 02 80689201	<a href="mailto:barbara.bertoglio@iegexpo.it">barbara.bertoglio@iegexpo.it</a>
		Nadia Magnabosco	+39 0444 969942	<a href="mailto:nadia.magnabosco@iegexpo.it">nadia.magnabosco@iegexpo.it</a>

**NOTICES TO EXHIBITING COMPANIES**

We hereby inform you that some companies, including "International Fairs Directory", "Mulpor Company Srl," "Oceandatalinks ", " Fortune Business Intelligence group inc - fortunebig ", based in different parts of the world and with constantly changing company names, are used to send our exhibiting companies forms in which they request to correct the data of the companies themselves, for the publication of advertisements, in online magazines, improperly using the trademarks of our events, or propose the sale of databases of names of buyers complete with company names, names of internal contacts, their contacts Email, website, addresses, telephone and fax. The companies of the aforementioned type **HAVE NOT BEEN AUTHORIZED BY US** to use our name or the brands connected to us. Therefore, an arbitrary and illegitimate use of the distinctive signs of others is evident, in order to create misunderstandings in the recipients of the aforementioned communications. It is also understood that **Italian Exhibition Group Spa has not communicated or transferred any data of its buyers to the companies that propose the sale of databases of our buyers.** In the event that you receive forms or proposals for the sales of database, also by e-mail, from the companies as specified above, we invite you to pay **MAXIMUM ATTENTION**, taking into account the above.

## FITTED BOOTH AREAS FORM - 4X4 SIZES

For any further information, visit:  
[www.koinexpo.com](http://www.koinexpo.com)

Italian Exhibition Group S.p.A. offers fitted booth areas in compliance with fire Safety measures.  
**N.B.1** Features and dimensions are purely indicative. **N.B.2** All prices have to be considered VAT not included.

### STANDARD STAND - Corner

4x4

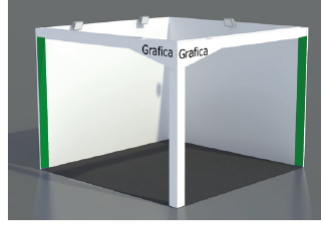
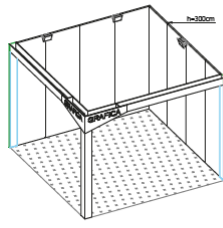
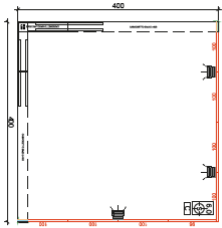

#### STANDARD STAND FITTING - Corner

Flammability class I blue carpet with protective covering nylon, white honeycomb sandwich panels 250/300 cm high with blue stripes, white wooden fascia board 8 cm thick 70 cm high with side 20x20 cm column, 3x 50 W led spotlights; 1x 500W power strip trapezoid corporate logo on fascia board; digital print on forex.

70,00 €/sqm

### STANDARD PLUS STAND - Corner

4x4

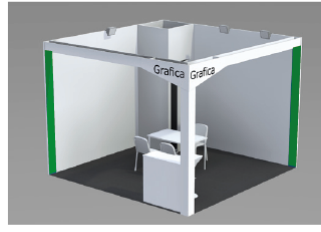
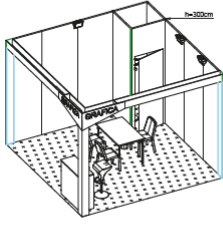
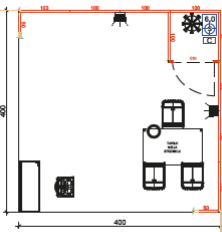

#### STANDARD PLUS STAND FITTING - Corner

The stand maintains the same fitting of STANDARD TYPE, it has to be added the FURNITURE PACKAGE that includes: 1 closet 1x1mt, 1 square table, 3 white chairs, 1 reception desk, 1 stool, 1 waste basket, 1 coat hanger.

70,00 €/sqm + 195,00 € furniture package

### SHOP STAND - Corner

4x4

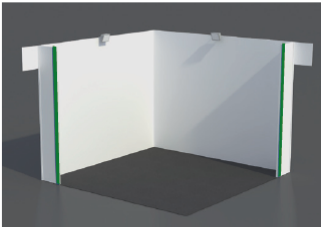
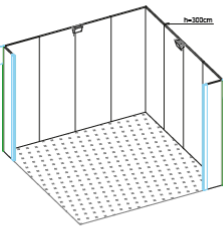
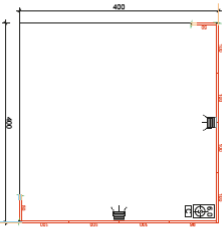

#### SHOP STAND FITTING - Corner

Flammability class I blue carpet with protective covering nylon, white honeycomb sandwich panels 250/300 cm high with blue stripes, white wooden fascia board 8 cm thick 70 cm high with side 20x20 cm column, 3x 50 W led spotlights; 1x 500W power strip trapezoid corporate logo on fascia board; digital print on forex.

60,00 €/mq

### SHOP PLUS STAND - Corner

4x4

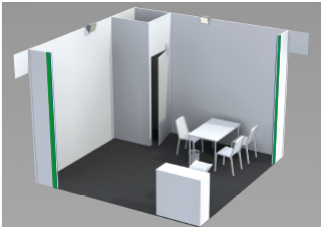
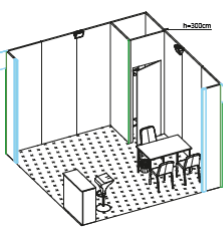
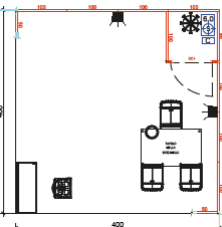

#### SHOP PLUS STAND FITTING - Corner

The stand maintains the same fitting of STANDARD TYPE, it has to be added the FURNITURE PACKAGE that includes: 1 closet 1x1mt, 1 square table, 3 white chairs, 1 reception desk, 1 stool, 1 waste basket, 1 coat hanger.

60,00 €/sqm + 195,00 € furniture package

### GENERAL TERMS OF SUPPLY

The Exhibitor, from taking over the material, is responsible for the proper use of the same, meaning this term the normal state of use, until the return, with the commitment to cover any and all costs deriving from and/or consequent to the improper and/or incorrect use of the rented materials until the complete reintegration of the same in the case are returned.